

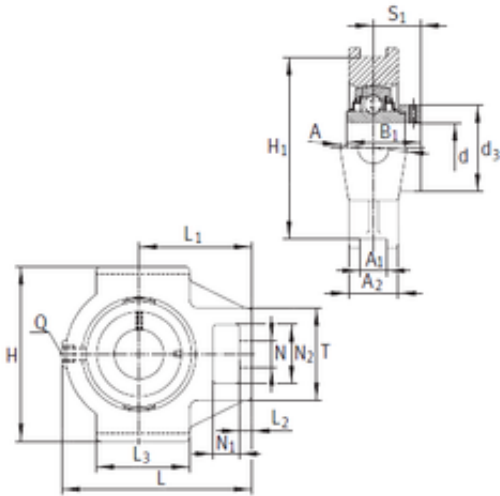

MRC DRIVESHAFT ANDERSON LTD

INA RTUE35 Take-Up Ball Bearing

Bearing No. RTUE35



RTUE35 Bearing 2D drawings and 3D CAD models

| | |
|-------------------------------|-----------------------|
| Bore Diameter | 35 mm |
| d | 35 mm |
| S1 | 32,5 mm |
| Thread (Q) | Rp1/8 |
| L2 | 13 mm |
| L3 | 63 mm |
| d3 | 51 mm |
| A | 40 mm |
| A1 | 12 mm |
| B1 | 51,3 mm |
| H | 102 mm |
| H1 | 89 mm |
| L | 131,5 mm |
| L1 | 80 mm |
| N | 22 mm |
| N1 | 18 mm |
| T | 64 mm |
| A2 | 30 mm |
| N2 | 36,5 mm |
| Weight | 1,8 Kg |
| Basic dynamic load rating (C) | 25,5 kN |
| Category | Take Up Unit Bearings |
| Inventory | 0.0 |
| Manufacturer Name | SCHAEFFLER GROUP |
| Minimum Buy Quantity | N/A |
| Weight / Kilogram | 1.8 |



MRC DRIVESHAFT ANDERSON LTD

| | |
|--------------------------|--|
| EAN | 4012802068801 |
| Product Group | M06110 |
| Component Description | Take Up Bearing Only |
| Rolling Element | Ball Bearing |
| Housing Style | Unit Only |
| Mounting Method | Eccentric Collar |
| Compatible Take Up Frame | Not Specified |
| Adjustment Travel Length | 0 |
| Insert Part Number | GE35KRRB |
| Housing Material | Cast Iron |
| Other Features | Single Row Spherical Double Land Riding Rubber Contact Seal |
| Inch - Metric | Metric |
| Long Description | Take Up Bearing Only; 35MM Bore; 12MM Slot Width; 89MM Slot to Slot Distance; Ball Bearing; Unit Only; Eccentric Collar Mount; GE35KRRB Insert Part; Cast Iron Housing Material |
| Category | Take Up Units |
| UNSPSC | 31171533 |
| Harmonized Tariff Code | 8483.20.40.40 |
| Noun | Bearing |
| Keyword String | Take Up |
| Manufacturer URL | http://www.ina.com |
| Weight / LBS | 3.969 |
| Slot Width | 0.472 Inch 12 Millimeter |
| Slot to Slot Distance | 3.504 Inch 89 Millimeter |
| Bore | 1.378 Inch 35 Millimeter |